

grosvenor
estate agents



145A New Road, Croxley Green, WD3 3EN
£1,550 Per Calendar Month



Floor Plan

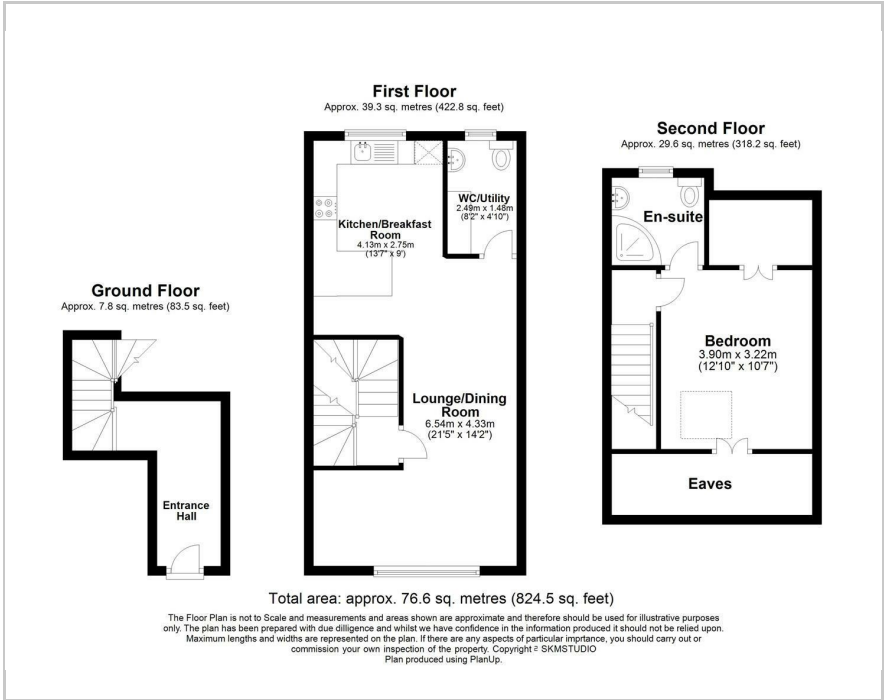

Area Map

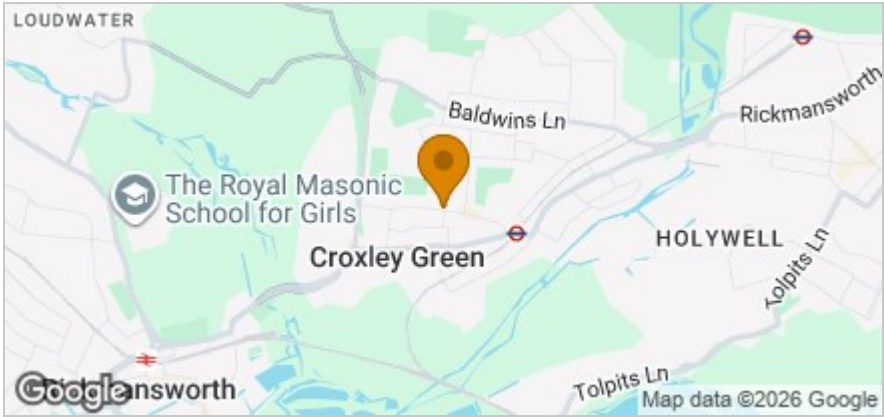

These particulars, whilst believed to be accurate are set out as a general outline only for guidance and do not constitute any part of an offer or contract. Intending purchasers should not rely on them as statements of representation of fact, but must satisfy themselves by inspection or otherwise as to their accuracy. No person in this firms employment has the authority to make or give any representation or warranty in respect of the property.

163 New Road, Croxley Green, Hertfordshire, WD3 3HB
Tel: 01923 711651 Email: sales@grosvenorestateagents.co.uk www.grosvenorestates.co.uk

Accommodation

- Brand New 1st Floor 1 Bed Conversion
- Modern Fitted Kitchen and Modern Ensuite Bathroom with Shower
- Separate Utility Room and Toilet
- Private Garden with Patio
- Off Street Parking - 1 Space
- A Short Walk to the Met Line Station
- Close to Shops and Amenities
- GSH - Double Glazing
- Built-in Data points for Internet
- EV Charging Points

Viewing

Please contact our Grosvenor Estate Agents Ltd Office on 01923 711651 if you wish to arrange a viewing appointment for this property or require further information.

Energy Efficiency Graph

